

Provincia											
Comune											
Livelle	L = 505.000	181.000	233.800	176.200	177.261	73.509	126.815				
DISL =	2.025	0.565	1.930	2.040	2.397	0.467	0.013				
p =	4.010										
Progr. Livelle	11268.440	3.122	11449.440	8.255	11683.240	11.578	11859.440	13.522	12036.701	12110.210	12237.025

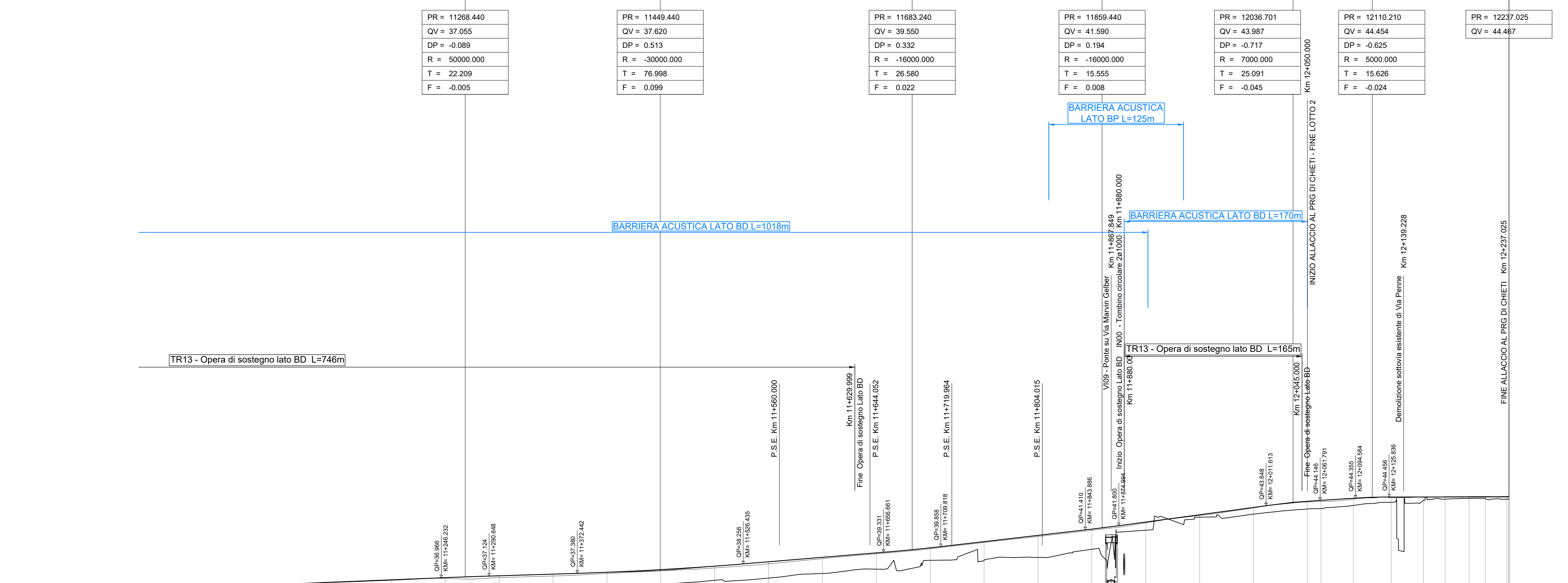

PR = 11268.440	PR = 11449.440	PR = 11683.240	PR = 11859.440	PR = 12036.701	PR = 12110.210	PR = 12237.025
QV = 37.055	QV = 37.620	QV = 39.550	QV = 43.987	QV = 41.590	QV = 44.454	QV = 44.467
DP = -0.089	DP = 0.513	DP = 0.332	DP = -0.717	DP = -0.717	DP = -0.565	DP = -0.330
R = 5000.000	R = 3000.000	R = 16000.000	R = 7000.000	R = 10000.000	R = 10000.000	R = 10000.000
T = 22.209	T = 76.598	T = 26.580	T = 15.628	T = 25.091	T = 15.628	T = 16.524
F = -0.005	F = 0.099	F = 0.022	F = 0.008	F = -0.045	F = -0.024	F = -0.014

NUMERO SEZIONE	266	267	268	269	270	271	272	273	274	275	276	277	278	279	280	281	282	283	284	285	286	287	288	289	290	291	292	
QUOTE PROGETTO	34.353	34.179	34.000	33.820	33.640	33.460	33.280	33.100	32.920	32.740	32.560	32.380	32.200	32.020	31.840	31.660	31.480	31.300	31.120	30.940	30.760	30.580	30.400	30.220	30.040	29.860	29.680	
QUOTE TERRENO	34.400	34.179	34.000	33.820	33.640	33.460	33.280	33.100	32.920	32.740	32.560	32.380	32.200	32.020	31.840	31.660	31.480	31.300	31.120	30.940	30.760	30.580	30.400	30.220	30.040	29.860	29.680	
ETOMETRICHE	1000	1000	1000	1000	1000	1000	1000	1000	1000	1000	1000	1000	1000	1000	1000	1000	1000	1000	1000	1000	1000	1000	1000	1000	1000	1000	1000	
DIST. PARZIALI	50.00	50.00	50.00	50.00	50.00	50.00	50.00	50.00	50.00	50.00	50.00	50.00	50.00	50.00	50.00	50.00	50.00	50.00	50.00	50.00	50.00	50.00	50.00	50.00	50.00	50.00	50.00	
PROGRESSIVE	1000.00	1050.00	1100.00	1150.00	1200.00	1250.00	1300.00	1350.00	1400.00	1450.00	1500.00	1550.00	1600.00	1650.00	1700.00	1750.00	1800.00	1850.00	1900.00	1950.00	2000.00	2050.00	2100.00	2150.00	2200.00	2250.00	2300.00	
ANDAMENTO PLANIMETRICO	L=192.38																											
SOPRAELEVAZIONE																												
VELOCITA'	60km/h																											
SCHEMATICO DEVIATI / RESPINGENTI	BINARIO PARL. BINARIO DISPARI																											

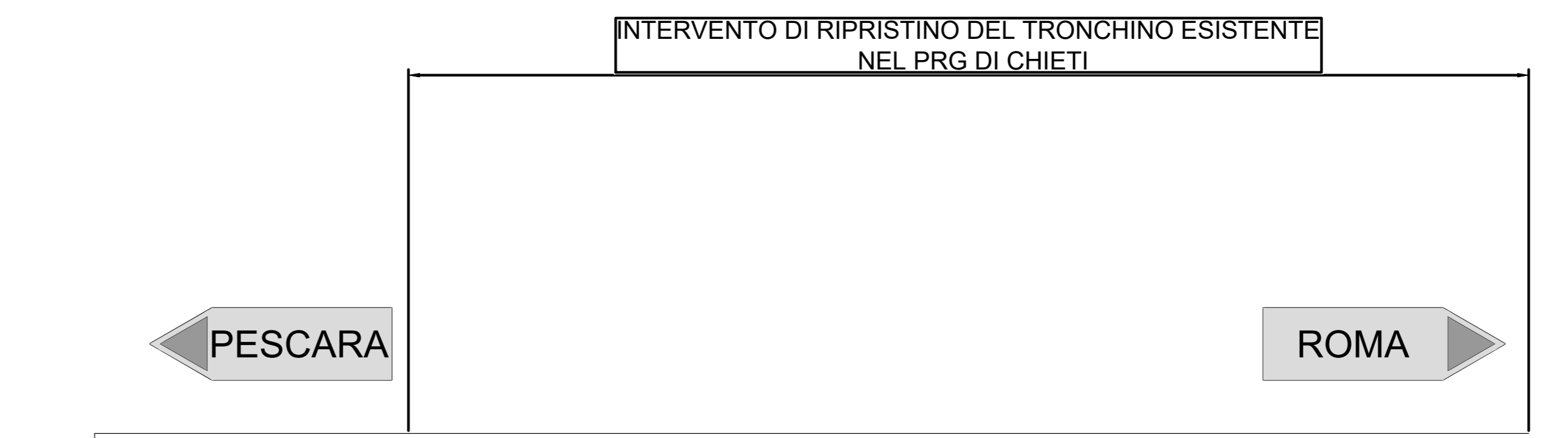

Provincia				
Comune				
Livelle	L = 80.000	170.023	220.939	220.939
DISL =	-0.180	0.570	0.010	0.010
p =	2.250	3.352	0.047	0.047
Progr. Livelle	80.000	80.000	250.023	470.961

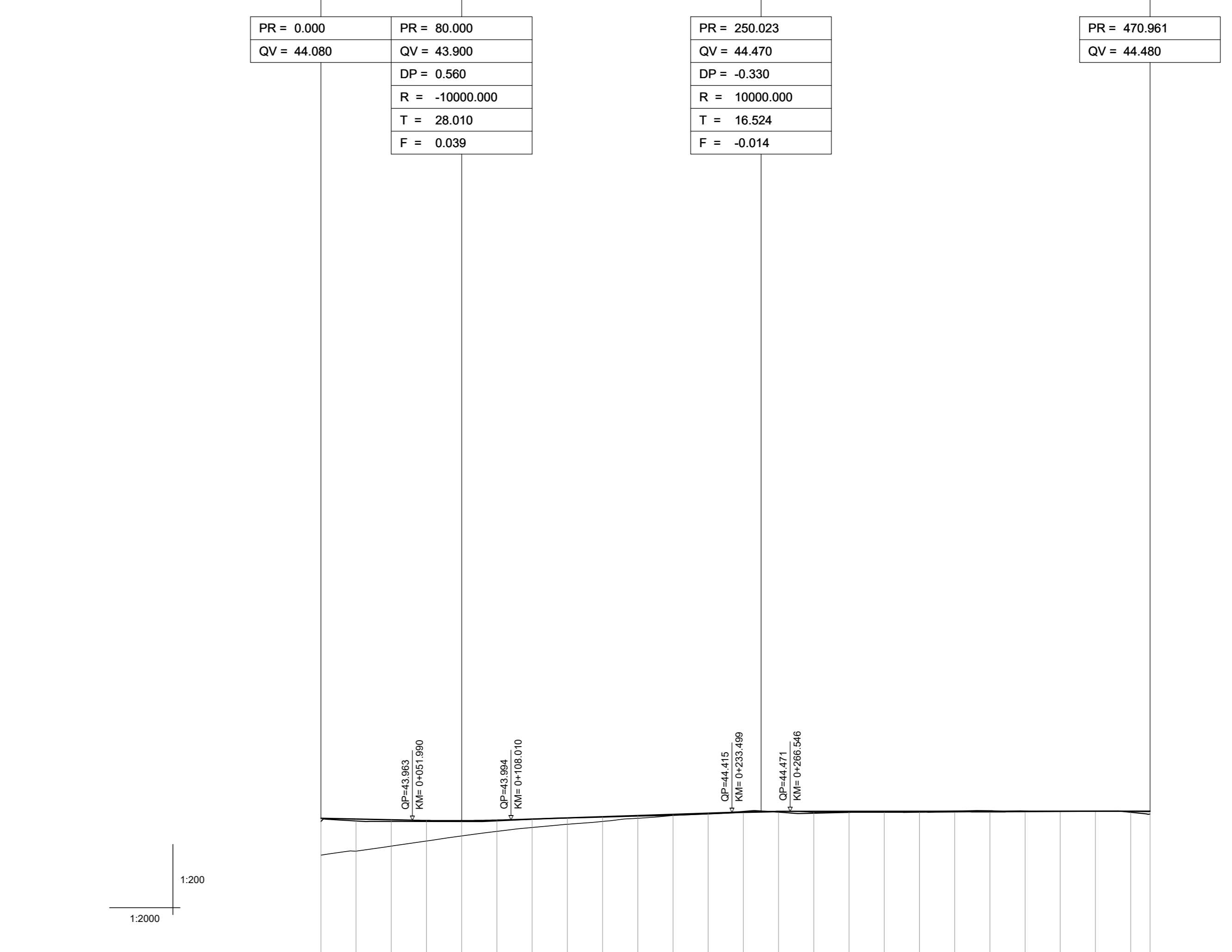

NUMERO SEZIONE	0	1	2	3	4	5	6	7	8	9	10	11	12	13	14	15	16	17	18	19	20	21	22	23	24	25	26	27	28	29	30	31	32	33	34	35	36	37	38	39	40	41	42	43	44	45	46	47	48	49	50																																																																																																																																																																																																																																																																																																																																																																																																																																																																																																																																																																																																																																																																																																																
QUOTE PROGETTO	43.963	43.925	43.887	43.849	43.811	43.773	43.735	43.697	43.659	43.621	43.583	43.545	43.507	43.469	43.431	43.393	43.355	43.317	43.279	43.241	43.203	43.165	43.127	43.089	43.051	43.013	42.975	42.937	42.899	42.861	42.823	42.785	42.747	42.709	42.671	42.633	42.595	42.557	42.519	42.481	42.443	42.405	42.367	42.329	42.291	42.253	42.215	42.177	42.139	42.101	42.063	42.025	41.987	41.949	41.911	41.873	41.835	41.797	41.759	41.721	41.683	41.645	41.607	41.569	41.531	41.493	41.455	41.417	41.379	41.341	41.303	41.265	41.227	41.189	41.151	41.113	41.075	41.037	40.999	40.961	40.923	40.885	40.847	40.809	40.771	40.733	40.695	40.657	40.619	40.581	40.543	40.505	40.467	40.429	40.391	40.353	40.315	40.277	40.239	40.201	40.163	40.125	40.087	40.049	40.011	39.973	39.935	39.897	39.859	39.821	39.783	39.745	39.707	39.669	39.631	39.593	39.555	39.517	39.479	39.441	39.403	39.365	39.327	39.289	39.251	39.213	39.175	39.137	39.099	39.061	39.023	38.985	38.947	38.909	38.871	38.833	38.795	38.757	38.719	38.681	38.643	38.605	38.567	38.529	38.491	38.453	38.415	38.377	38.339	38.301	38.263	38.225	38.187	38.149	38.111	38.073	38.035	37.997	37.959	37.921	37.883	37.845	37.807	37.769	37.731	37.693	37.655	37.617	37.579	37.541	37.503	37.465	37.427	37.389	37.351	37.313	37.275	37.237	37.199	37.161	37.123	37.085	37.047	37.009	36.971	36.933	36.895	36.857	36.819	36.781	36.743	36.705	36.667	36.629	36.591	36.553	36.515	36.477	36.439	36.401	36.363	36.325	36.287	36.249	36.211	36.173	36.135	36.097	36.059	36.021	35.983	35.945	35.907	35.869	35.831	35.793	35.755	35.717	35.679	35.641	35.603	35.565	35.527	35.489	35.451	35.413	35.375	35.337	35.299	35.261	35.223	35.185	35.147	35.109	35.071	35.033	34.995	34.957	34.919	34.881	34.843	34.805	34.767	34.729	34.691	34.653	34.615	34.577	34.539	34.501	34.463	34.425	34.387	34.349	34.311	34.273	34.235	34.197	34.159	34.121	34.083	34.045	34.007	33.969	33.931	33.893	33.855	33.817	33.779	33.741	33.703	33.665	33.627	33.589	33.551	33.513	33.475	33.437	33.399	33.361	33.323	33.285	33.247	33.209	33.171	33.133	33.095	33.057	33.019	32.981	32.943	32.905	32.867	32.829	32.791	32.753	32.715	32.677	32.639	32.601	32.563	32.525	32.487	32.449	32.411	32.373	32.335	32.297	32.259	32.221	32.183	32.145	32.107	32.069	32.031	31.993	31.955	31.917	31.879	31.841	31.803	31.765	31.727	31.689	31.651	31.613	31.575	31.537	31.499	31.461	31.423	31.385	31.347	31.309	31.271	31.233	31.195	31.157	31.119	31.081	31.043	31.005	30.967	30.929	30.891	30.853	30.815	30.777	30.739	30.701	30.663	30.625	30.587	30.549	30.511	30.473	30.435	30.397	30.359	30.321	30.283	30.245	30.207	30.169	30.131	30.093	30.055	30.017	29.979	29.941	29.903	29.865	29.827	29.789	29.751	29.713	29.675	29.637	29.599	29.561	29.523	29.485	29.447	29.409	29.371	29.333	29.295	29.257	29.219	29.181	29.143	29.105	29.067	29.029	28.991	28.953	28.915	28.877	28.839	28.801	28.763	28.725	28.687	28.649	28.611	28.573	28.535	28.497	28.459	28.421	28.383	28.345	28.307	28.269	28.231	28.193	28.155	28.117	28.079	28.041	28.003	27.965	27.927	27.889	27.851	27.813	27.775	27.737	27.699	27.661	27.623	27.585	27.547	27.509	27.471	27.433	27.395	27.357	27.319	27.281	27.243	27.205	27.167	27.129	27.091	27.053	27.015	26.977	26.939	26.901	26.863	26.825	26.787	26.749	26.711	26.673	26.635	26.597	26.559	26.521	26.483	26.445	26.407	26.369	26.331	26.293	26.255	26.217	26.179	26.141	26.103	26.065	26.027	25.989	25.951	25.913	25.875	25.837	25.799	25.761	25.723	25.685	25.647	25.609	25.571	25.533	25.495	25.457	25.419	25.381	25.343	25.305	25.267	25.229	25.191	25.153	25.115	25.077	25.039	25.001	24.963	24.925	24.887	24.849	24.811	24.773	24.735	24.697	24.659	24.621	24.583	24.545	24.507	24.469	24.431	24.393	24.355	24.317	24.279	24.241	24.203	24.165	24.127	24.089	24.051	24.013	23.975	23.937	23.899	23.861	23.823	23.785	23.747	23.709	23.671	23.633	23.595	23.557	23.519	23.481	23.443	23.405	23.367	23.329	23.291	23.253	23.215	23.177	23.139	23.101	23.063	23.025	22.987	22.949	22.911	22.873	22.835	22.797	22.759	22.721	22.683	22.645	22.607	22.569	22.531	22.493	22.455	22.417	22.379	22.341	22.303	22.265	22.227	22.189	22.151	22.113	22.075	22.037	21.999	21.961	21.923	21.885	21.847	21.809	21.771	21.733	21.695	21.657	21.619	21.581	21.543	21.505	21.467	21.429	21.391	21.353	21.315	21.277	21.239	21.201	21.163	21.125	21.087	21.049	21.011	20.973	20.935	20.897	20.859	20.821	20.783	20.745	20.707	20.669	20.631	20.593	20.555	20.517	20.479	20.441	20.403	20.365	20.327	20.289	20.251	20.213	20.175	20.137	20.099	20.061	20.023	19.985	19.947	19.909	19.871	19.833	19.795	19.757	19.719	19.681	19.643	19.605	19.567	19.529	19.491	19.453	19.415	19.377	19.339	19.301	19.263	19.225	19.187	19.149	19.111	19.073	19.035	18.997	18.959	18.921	18.883	18.845	18.807	18.769	18.731	18.693	18.655	18.617	18.579	18.541	18.503	18.465	18.427	18.389	18.351	18.313	18.275	18.237	18.199	18.161	18.123	18.085	18.047	18.009	17.971	17.933	17.895	17.857	17.819	17.781	17.743	17.705	17.667	17.629	17.591	17.553	17.515	17.477	17.439	17.401	17.363	17.325	17.287	17.249	17.211	17.173	17.135	17.097	17.059	17.021	16.983	16.945	16.907	16.869	16.831	16.793	16.755	16.717	16.679	16.641	16.603	16.565	16.527	16.489	16.451	16.413	16.375	16.337	16.299	16.261	16.223	16.185	16.147	16.109	16.071	16.033	15.995	15.957	15.919</